

## STS5801E\_LCD Single Monitor Computer Desk

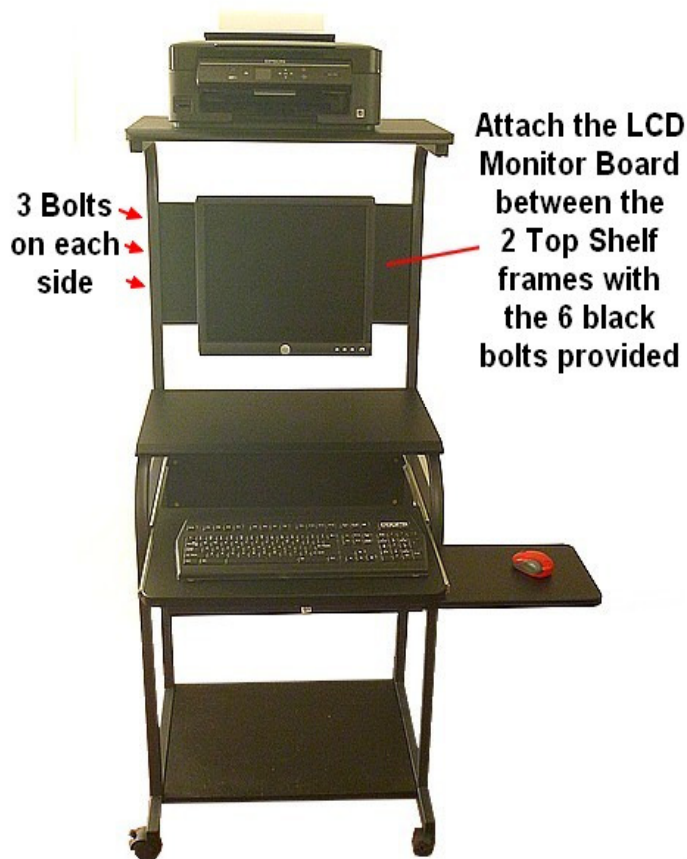

The image on the left shows the **STS5801E\_Single LCD** Desk with one 16" wide monitor attached.

The monitor attaches to the **rear monitor board**, which mounts between the 2 vertical frames with the 6 bolts provided in the monitor board kit.

As you will see with more detail on the next page, one part of the LCD Monitor bracket attaches to the back of the monitor, and the other side to the board. Then you just hang the monitor onto the board's brackets and secure it with 3 bolts on the sides of the bracket

See this sheet much better, in colors:

[http://1-computerdesks.com/pdf/5801E\\_LCD\\_Bracket.pdf](http://1-computerdesks.com/pdf/5801E_LCD_Bracket.pdf)

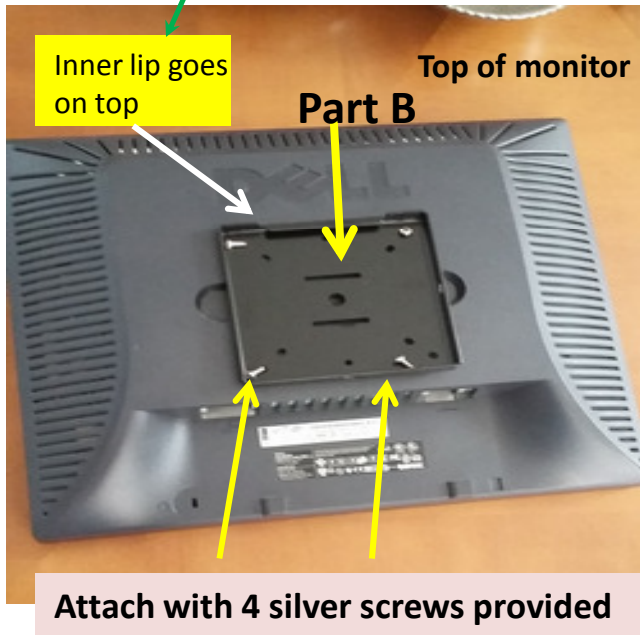
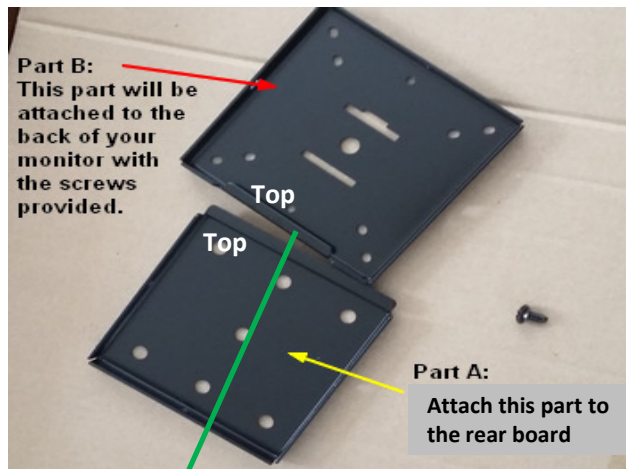

## How to mount the Monitor

**Step 1: Attach Monitor Board** between the 2 vertical top-shelf frames and secure it with the 6 2" long bolts provided.

**Step 2: Attach the Monitor:** the monitor bracket has 2 parts. **Part A**, which you will attach to the desk's Monitor Board, and **Part B**, which you will attach to the back of your Monitor on the monitor's VESA holes. Then, you simply hang the monitor onto the Monitor Board by hanging **Part B** to **Part A**.

Attach **Part B** to the back of your monitor, using the provided VESA screws. Please note that **Part B** has a inner lip "aiming down" which will have to catch the lip that is "aiming up" on **Part A**. When you attach this Part A to the board, be sure that the inner lip side is facing upwards as shown in the 2<sup>nd</sup> image.

Once you have attached **Part B** to the monitor, you simple "hang" the monitor onto **Part A**, as shown in this 3<sup>rd</sup> image.

The last image shows how the bracket works,

This image just shows the bracket parts without the monitor or the desk's rear board, so you can see how they mate together.

**Questions?** Just contact us at [info@1-computerdesks.com](mailto:info@1-computerdesks.com)

See this sheet much better, in colors:

[http://1-computerdesks.com/pdf/5801E\\_LCD\\_Bracket.pdf](http://1-computerdesks.com/pdf/5801E_LCD_Bracket.pdf)